



1 Ethan Allen Homestead Burlington, VT 05408

[www.ethanallenhomestead.org](http://www.ethanallenhomestead.org)

(802) 865-4556

[ethanallenhomestead@gmail.com](mailto:ethanallenhomestead@gmail.com)

## Call for Artists

### Overview

The Ethan Allen Homestead Museum is seeking artists to create art narrative backdrops to enhance posed and costumed mannequins in an exhibition commemorating the 250th anniversary of the American Revolutionary War. This exhibit will highlight people who have rarely been interpreted in museums. Emerging artists, student artists, and artists with diverse backgrounds and identities are encouraged to apply. Application deadline is January 24, 2025. Art must be submitted to the museum by February 24, 2025.

### Storytelling Goals

People featured in the exhibit: (one art piece per person featured)

- Martha Winslow Powell: one of the first European residents of Burlington; fled from War in 1776; gave birth in the woods while watching her home burn during a war raid
- William Marsh: fought with the Green Mountain Boys early in the war, then joined the British; taken prisoner by the Americans, exiled to Canada, and land confiscated
- Fanny Buchanan: fled Vermont as war refugee; married a soldier who died in battle; gender and political affiliation inhibited her claim to inherited property in Vermont
- Newport: Black or African man; farmer; unknown age & unknown legal status due to lack of records and inconsistent enforcement of 1777 Vermont constitutional ban on adult slavery
- Joseph Louis Gill: Abenaki chief; military commissions from British and Americans; focused on community preservation; American victory meant further land displacement for Abenakis
- Ethan Allen: Led 1775 capture of Fort Ticonderoga, then prisoner-of-war through 1777; published a best-selling memoir of these experiences (focusing on prisoner-of-war experiences)
- Winooski River: the reason for human occupation at the Homestead site for millenia; feeds into Lake Champlain, a major strategic location of the war; American victory led to increased settlement and pollution (not a person, but featured like a person in the exhibit)

The Museum will commission seven different art pieces, one for each person featured in the exhibit. The art pieces will serve as backdrops for each person's niche (more details below).

Interpretive themes of the exhibit include:

- Varied Revolutionary War experiences affected by race, gender, and political identity
- The making of the Vermont Republic and the United States
- The use of the Ethan Allen Homestead site & nearby sites 1775-1777 during the war
- Inspiring and inconsistent applications of American & Vermont constitutional principles

Audience: Approximately 16,500 people and 50 school groups will view the exhibit. The exhibit will open May 2025 and run through October 2027.



1 Ethan Allen Homestead Burlington, VT 05408

[www.ethanallenhomestead.org](http://www.ethanallenhomestead.org)

(802) 865-4556

[ethanallenhomestead@gmail.com](mailto:ethanallenhomestead@gmail.com)

## Scope of Work

Artists who are chosen will receive a short essay (5-7 pages) from the museum about the person to use as inspiration for their piece(s). Art pieces will enhance the story of the person's Revolutionary War experience and may extend to include the impact of the Revolution's lasting cultural legacies on the individual and their community. Artists can apply to create one art piece (one featured person) or multiple pieces.

Art pieces will serve as backdrops in niches behind posed & costumed mannequins.

Niche dimensions are 49" wide, 84" tall, and 36" deep. Images for reference included here:

Various art mediums will be considered.

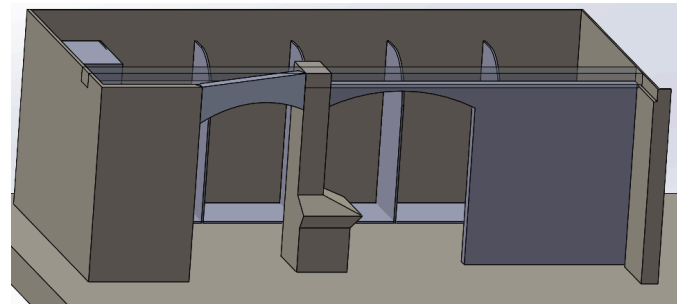
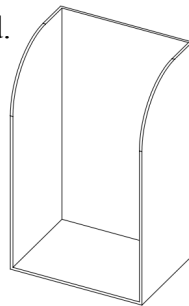

## Estimated Timeline

Artist applications due: January 24, 2025

EAHM replies to applications: by January 31, 2025

Delivery/installation of art pieces in the museum: no later than February 24, 2025

Exhibit opens: May 1, 2025

## Budget

\$850 per art piece (7 art pieces total)

This project is funded by grants from the Vermont Arts Council and the Vermont Historical Society.

## How to Apply

Please send questions & applications to [director@ethanallenhomestead.org](mailto:director@ethanallenhomestead.org). Applications should include:

1. Resume
2. Links to or pictures of 2-3 sample art pieces
3. One reference
4. Person(s) in the exhibit for whom you're interested in creating art piece(s)
5. Brief statement (1-2 sentences) about why you're interested in creating an art piece to tell that person's story & what medium(s) you'll use

**Application Deadline: January 24, 2025**